

LINCOLN COUNTY, MONTANA  
**CERTIFICATE OF SURVEY**  
A PARCEL OF LAND IN LOT 3 AND LOT 2 SECTION 30,  
TWP. 31N., R. 31W., P.M.M.

**DESCRIPTION PARCEL "A"**

A parcel of land in Lot 3 and Lot 2 of Section 30, T31 N, R 31 W, P.M.M., and more particularly described as follows:  
Beginning at a 5/8 inch dia. rebar capped: MDL 4232S located on the Northerly right-of-way line of Burlington Northern Railroad also being the Southeast Corner of that 8.127 acre tract of land as shown on C. of S. No. 530; thence, along said right-of-way line S 59°00'00" E 425.84 feet to a 5/8 inch dia. rebar capped: KED 4975 S; thence, leaving said right-of-way line N 49°15'33" E 334.96 feet to a 5/8 inch dia. rebar capped: KED 4975 S (set as a reference); thence, N 49°15'33" E 50.88 feet to the G.L.O. meander line; thence, downriver along said meander line N 30°30' W 482.17 feet; thence, downriver along said meander line N 62°30' W 123.22 feet to the Northeasterly corner of that 8.127 acre tract of land as shown on C. of S. No. 530; thence, leaving said meander line along the Southeasterly line of said tract as shown on C. of S. No. 530 S 31°00' W 43.21 feet to a 5/8 inch dia. rebar capped: MDL 4232 S; thence, S 31°00' W 545.75 feet to the point of beginning.  
This parcel "A" contains 5.849 acres more or less and includes any land lying between the meander line and the low water mark of the Kootenai River.

**PURPOSE OF SURVEY/EXEMPTION CERTIFICATE**

I hereby certify that the purpose of the division of Parcel "A" is to transfer ownership of said Parcel "A" created as an occasional sale; furthermore, I certify that I am entitled to use this exemption in that I am in compliance with all conditions imposed in the use of this exemption; therefore, this division of land is exempt from review as a subdivision pursuant to Section 76-3-207 (d) M.C.A.

DATE: 6-14-89 Harold Wilburn  
Harold Wilburn

STATE OF MONTANA.  
COUNTY OF LINCOLN.

On this 14th day of June, 1989 A.D., before me, a Notary Public in and for the State of Montana, personally appeared Harold Wilburn, known to me to be the person whose name is subscribed to the within instrument, and acknowledged to me that he executed the same.

Janice Dennis Notary Public  
4-25-90 My Commission Expires

C. OF S. No. 530

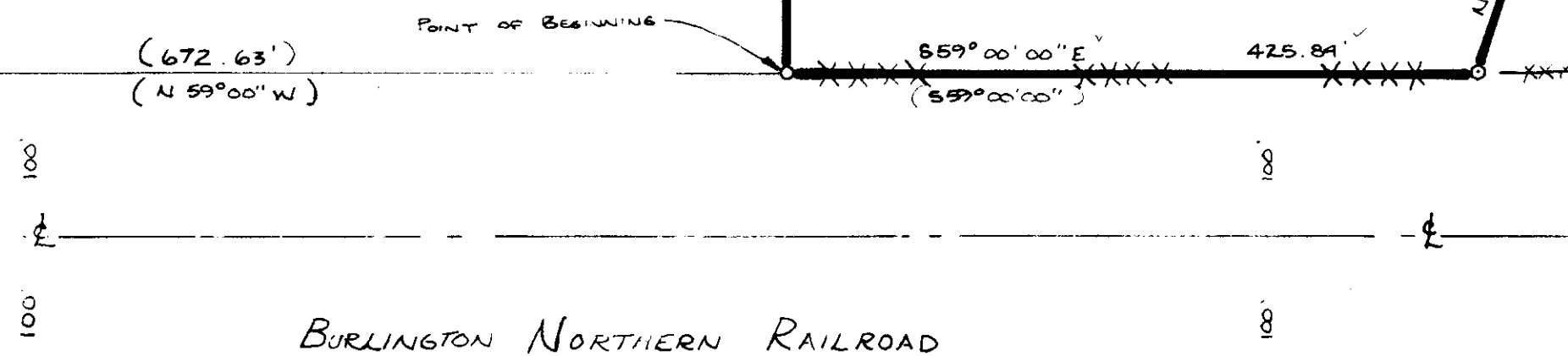

**LEGEND**

- O SET 5/8" REBAR CAPPED K.E.D. 4975S.
- O FOUND A 5/8" REBAR & CAP M.D.L. 4232S.
- COMPUTED POINT NOT SET.
- [ ] RECORD PER G.L.O. NOTES.
- ( ) RECORD PER C. OF S. No. 530.
- XXXX FENCE

SCALE : 1" = 100'

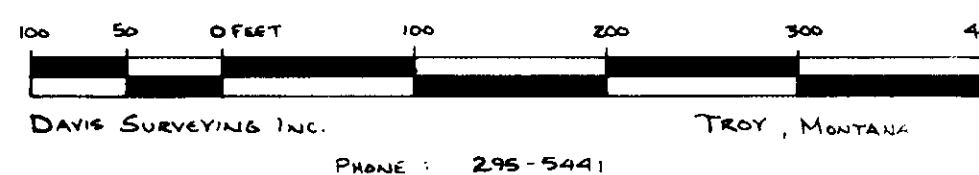

**TAX CERTIFICATION**

I hereby certify that no real property taxes assessed and levied on the land to be divided are delinquent.  
Dated this 14th of June, 1989.

Delores J. Homack  
Treasurer, Lincoln County, Montana

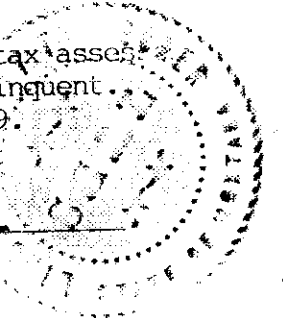

EXAMINED AND APPROVED FOR LINCOLN COUNTY BY: Bill J. Buckhoff

APPROVED: Jim R. Morey DATE: \_\_\_\_\_  
Chairman, Lincoln County, Montana Commissioners

CERTIFICATE OF COUNTY CLERK AND RECORDER

STATE OF MONTANA. COUNTY OF LINCOLN.

Filed on this 14th day of June, 1989 A.D. at 10:50 o'clock A.M.  
Janice Dennis by Sherry L. Hawks  
County Clerk and Recorder Deputy

**CERTIFICATE OF SURVEY No. 1702**

*Sanitary restrictions removed 8/24/89*