

FOR: THOMAS G. BITTERMAN
 DATE: NOVEMBER, 1986.

LINCOLN COUNTY, MONTANA.
CERTIFICATE OF SURVEY

RAWLINGS ROAD
 SUBDIVISION
 DEAN CLAIR & VALERIE
 JEAN CRABTREE

FOR: THOMAS G. BITTERMAN
 DATE: NOVEMBER, 1986.

U.S. IN LOT 1 OF SECTION 32 AND LOT 1 OF SECTION 33 TWP. 31 N., R. 31 W., P.M.M.

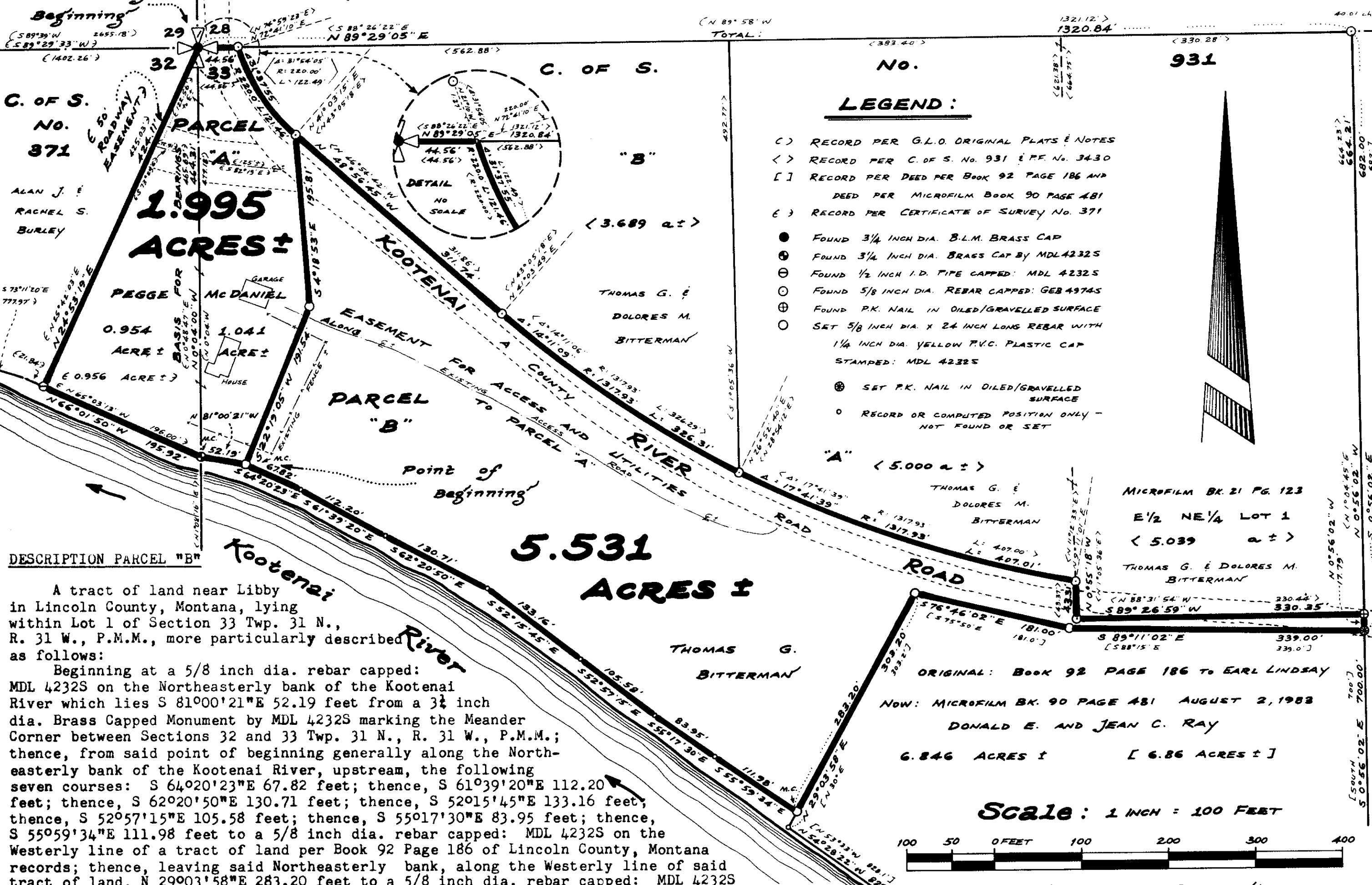

LEGEND:

- () RECORD PER G.L.O. ORIGINAL PLATS & NOTES
- < > RECORD PER C. OF S. No. 931 & P.F. No. 3430
- [] RECORD PER DEED PER BOOK 92 PAGE 186 AND DEED PER MICROFILM BOOK 90 PAGE 481
- () RECORD PER CERTIFICATE OF SURVEY No. 371
- FOUND 3/4 INCH DIA. B.L.M. BRASS CAP
- ⊙ FOUND 3/4 INCH DIA. BRASS CAP BY MDL 4232S
- ⊖ FOUND 1/2 INCH I.D. PIPE CAPPED: MDL 4232S
- ⊕ FOUND 5/8 INCH DIA. REBAR CAPPED: GEB 4974S
- ⊗ FOUND P.K. NAIL IN OILED/GRAVELLED SURFACE
- SET 5/8 INCH DIA. X 24 INCH LONG REBAR WITH 1/4 INCH DIA. YELLOW P.V.C. PLASTIC CAP STAMPED: MDL 4232S
- ⊙ SET P.K. NAIL IN OILED/GRAVELLED SURFACE
- RECORD OR COMPUTED POSITION ONLY - NOT FOUND OR SET

DESCRIPTION PARCEL "A"

A tract of land near Libby in Lincoln County, Montana, lying within Lot 1 of Section 32 and Lot 1 of Section 33 Twp. 31 N., R. 31 W., P.M.M., more particularly described as follows:

Beginning at a 3/4 inch dia. B.L.M. Brass Capped Monument marking the Northerly corner common to said Sections 32 and 33; thence, along the North line of said Section 33, N 89°29'05"E 44.56 feet to a point on the Southwesterly line of Certificate of Survey No. 931 from which a 5/8 inch dia. rebar capped: GEB 4974S bears N 21°10'W 1.27 feet; thence, along the Southwesterly line of said C. of S. No. 931, southeasterly on the arc of a curve to the left having a radius of 220.00 feet, which radius bears N 72°41'10"E, turning through a central angle of 31°37'55" an arc length of 121.46 feet to a 5/8 inch dia. rebar capped: GEB 4974S where the radius bears N 41°03'15"E; thence, leaving said Southwesterly line, S 4°18'53"E 195.81 feet to a 5/8 inch dia. rebar capped: MDL 4232S; thence, S 22°19'05"W 191.54 feet to a 5/8 inch dia. rebar capped: MDL 4232S on the Northeasterly bank of the Kootenai River; thence, generally along said Northeasterly bank, downstream, N 81°00'21"W 52.19 feet to a 3/4 inch dia. Brass Capped Monument by MDL 4232S marking the Meander Corner between said Sections 32 and 33; thence, in said Section 32, continuing generally along said Northeasterly bank, N 66°01'50"W 195.92 feet to a 1/2 inch I.D. pipe capped: MDL 4232S marking the Southeastery corner of Certificate of Survey No. 371; thence, leaving said Northeasterly bank, along the Easterly line of said C. of S. No. 371, N 24°53'19"E 424.11 feet to the point of beginning.

The aforescribed Parcel "A" contains 1.995 acres, more or less, of which 0.954 acre, more or less, falls in said Section 32 and 1.041 acre, more or less, falls in said Section 33.

The aforescribed Parcel "A" is SUBJECT to a 50.00 foot wide Roadway Easement at the northerly end thereof from the Kootenai River Road to the Easterly line of said C. of S. No. 371 along an existing road generally as delineated hereon as per said C. of S. No. 371.

The aforescribed Parcel "A" also INCLUDES an Easement for Access and Utilities along an Existing Access Road from the Kootenai River Road, crossing through Parcel "B", to the Easterly line of Parcel "A", generally as delineated hereon.

PURPOSE FOR SURVEY/EXEMPTION CERTIFICATION

I hereby certify that the purpose for this survey is to create partition Parcels "A" and "B" by order of the District Court of the State of Montana in and for the County of Lincoln per Court Records DV-86-160 ; therefore, this survey is exempt from review as a subdivision pursuant to Section 76-3-201 (1), M.C.A. This survey is also exempt from review by the Department of Health and Environmental Sciences pursuant to ARM 16-2.14(10)-514340 Sub-chapter 6 Exclusions 16.16.605 (1)(a).

Date: 12/4/86
 Melvin D. Lauteren
 Melvin D, Lauteren Registration No. 4232S

STATE OF MONTANA. COUNTY OF LINCOLN.

On this 4th day of December, 1986 A.D., before me, a Notary Public in and for the State of Montana, personally appeared Melvin D. Lauteren, known to me to be the person whose name is subscribed to the within instrument, and acknowledged to me that he executed the same.

Johnson Harrington
 Notary Public My Commission Expires April 18, 1989

CERTIFICATE OF COUNTY CLERK AND RECORDER

STATE OF MONTANA. COUNTY OF LINCOLN.

Filed on this 21st day of January, 1987 A.D. at 12:05 o'clock P.M.

Janet B. J. Siegel
 County Clerk and Recorder

by Sherry L. Hawks
 Deputy

CERTIFICATE OF SURVEY No. 1540

DESCRIPTION PARCEL "B"

A tract of land near Libby in Lincoln County, Montana, lying within Lot 1 of Section 33 Twp. 31 N., R. 31 W., P.M.M., more particularly described as follows:

Beginning at a 5/8 inch dia. rebar capped: MDL 4232S on the Northeasterly bank of the Kootenai River which lies S 81°00'21"E 52.19 feet from a 3/4 inch dia. Brass Capped Monument by MDL 4232S marking the Meander Corner between Sections 32 and 33 Twp. 31 N., R. 31 W., P.M.M.; thence, from said point of beginning generally along the Northeasterly bank of the Kootenai River, upstream, the following seven courses: S 64°02'23"E 67.82 feet; thence, S 61°39'20"E 112.20 feet; thence, S 62°02'50"E 130.71 feet; thence, S 52°15'45"E 133.16 feet; thence, S 52°57'15"E 105.58 feet; thence, S 55°17'30"E 83.95 feet; thence, S 55°59'34"E 111.98 feet to a 5/8 inch dia. rebar capped: MDL 4232S on the Westerly line of a tract of land per Book 92 Page 186 of Lincoln County, Montana records; thence, leaving said Northeasterly bank, along the Westerly line of said tract of land, N 29°03'58"E 283.20 feet to a 5/8 inch dia. rebar capped: MDL 4232S marking the Northwest corner thereof; thence, along the Northerly line of said tract of land, S 76°46'02"E 181.00 feet to a 5/8 inch dia. rebar capped: MDL 4232S; thence, S 89°11'02"E 339.00 feet to a P.K. nail marking the Northeast corner of said tract of land on the East line of Lot 1 of said Section 33; thence, along the East line of said Lot 1, N 0°56'02"W 17.79 feet to a P.K. Nail marking the Southeast corner of the East 1/2 of the NE 1/4 of said Lot 1 per Certificate of Survey No. 931; thence, along the South line of the East 1/2 of the NE 1/4 of said Lot 1, S 89°26'59"W 330.35 feet to a 5/8 inch dia. rebar capped: GEB 4974S marking the Southwest corner thereof; thence, along the West line of the East 1/2 of the NE 1/4 of said Lot 1, N 0°55'18"W 43.31 feet to a 5/8 inch dia. rebar capped: GEB 4974S marking the Southeast corner of Tract "A" per said C. of S. No. 931; thence, along the Southwesterly line of said Tract "A", northwesterly on the arc of a curve to the right having a radius of 1317.93 feet, which radius bears N 9°11'01"E, turning through a central angle of 17°41'39" an arc length of 407.01 feet to a 5/8 inch dia. rebar capped: GEB 4974S marking the Southeast corner of Tract "B" per said C. of S. No. 931; thence, along the Southwesterly line of said Tract "B", Northwesterly on the arc of a curve to the right having a radius of 1317.93 feet, which radius bears N 26°52'40"E, turning through a central angle of 14°11'09" an arc length of 326.31 feet to a 5/8 inch dia. rebar capped: GEB 4974S; thence, N 48°56'45"W 311.74 feet to a 5/8 inch dia. rebar capped: GEB 4974S; thence, leaving said Southwesterly line, S 4°18'53"E 195.81 feet to a 5/8 inch dia. rebar capped: MDL 4232S; thence, S 22°19'05"W 191.54 feet to the point of beginning.

The aforescribed Parcel "B" contains 5.531 acres, more or less, and also includes any land lying between the meander line as delineated hereon and the low water line of the Kootenai River.

The aforescribed Parcel "B" is SUBJECT to an Easement for Access and Utilities along an Existing Access Road from the Kootenai River Road, crossing through said Parcel "B", to the Easterly line of Parcel "A", generally as delineated hereon.

APPROVED: This 21st day of January, 1987 A.D.
Sheriff
 Examining Land Surveyor Registration No. _____

APPROVED: Spencer Williams
 Chairman, Lincoln County, Montana Commissioners