

OWNER: UNSER HOFF CORPORATION  
PURPOSE: CEMETERY LOTS  
DATE: AUGUST 13, 1980

## LEGAL DESCRIPTION

THAT PORTION OF THE SOUTHEAST  $\frac{1}{4}$  OF THE SOUTHWEST  $\frac{1}{4}$ , SECTION 11, TOWNSHIP 37 NORTH, RANGE 28 WEST, P.M., M., LINCOLN COUNTY, MONTANA DESCRIBED AS FOLLOWS:  
COMMENCING AT THE SOUTHEAST CORNER OF THE SOUTHWEST  $\frac{1}{4}$  OF SECTION 11; THENCE ALONG THE SOUTH LINE OF THE SOUTHWEST  $\frac{1}{4}$  WEST 717.14 FEET TO THE POINT OF BEGINNING; THENCE CONTINUING ALONG THE SOUTH LINE OF THE SOUTHWEST  $\frac{1}{4}$  WEST 50.01 FEET; THENCE NORTH  $20^{\circ}36'04''$  EAST 156.94 FEET; THENCE SOUTH  $89^{\circ}58'24''$  EAST 50.00 FEET; THENCE SOUTH  $20^{\circ}35'53''$  WEST 156.92 FEET TO THE POINT OF BEGINNING, CONTAINING 0.169 ACRE OF LAND, ALL AS SHOWN HEREON.

CERTIFICATE OF SURVEYOR

I CERTIFY THAT THE PURPOSE OF THIS SURVEY IS TO CREATE CEMETERY LOTS. IT IS THEREFORE EXEMPT FROM THE PROVISIONS OF THE SUBDIVISION AND PLATTING ACT AND THE SANITATION IN SUBDIVISIONS ACT.

CERTIFICATE OF SURVEYOR

*D.K. Marquardt*  
D.K. MARQUARDT  
REGISTRATION No. 2989 ES

APPROVED: 10/8, 1980

EXAMINING LAND SURVEYOR  
REGISTRATION NO. 4774-S

STATE OF MONTANA  
COUNTY OF LINCOLN

FILED ON THE 15<sup>th</sup> DAY OF October, 1980, A.D., AT 1:10 O'CLOCK P.M.

Glenn L. Taughn  
COUNTY CLERK AND RECORDER

BY Betty Buss

DEED BOOK \_\_\_\_\_ PAGE \_\_\_\_\_

INSTRUMENT REC. No. \_\_\_\_\_

BW Lindsey  
COUNTY COMMISSIONER

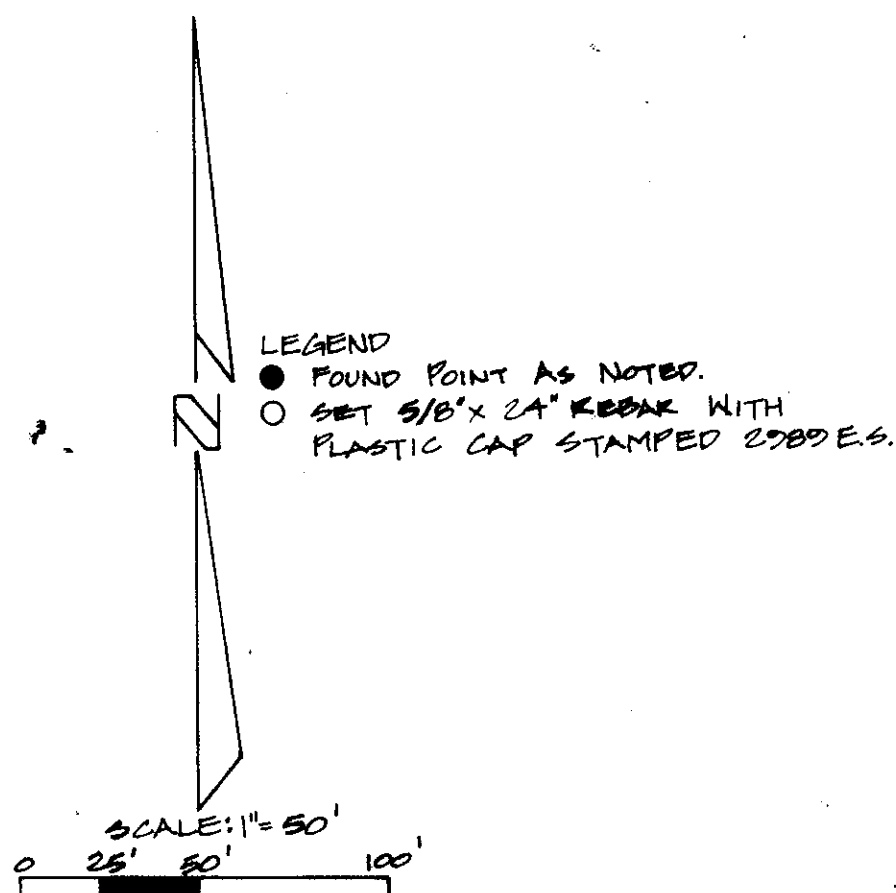

Prepared by: MARQUARDT ENGINEERING & SURVEYING  
1031 South Main  
Kalispell, MT. 59901 ph. 755-6285

CERTIFICATE OF SURVEY No. 841

AMISH CEMETERY

indexed plotted